

**Notes**

- All dimensions in metres unless noted otherwise. All levels are in metres Above Ordnance Datum (mAOD).
- The height of proposed bridges, embankments and depths of cuttings are indicative subject to the limits of deviation referred to in the order.
- The proposed works including their specific alignment will be subject to detailed design within the limits of deviation identified on the works plans and as described in Article 4 of the development consent order.

**Legend**

- Proposed Ground Level
- Existing Ground Level
- Area of Cut
- Area of Fill
- Departure from Standard
- Combination of Relaxations that results in a Departure from Standard
- Area of Structure/Bridge

**Highway Plans**  
Refer to Document 2.7B for:  
• M40 Junction 10

**Highway Plans Cross Sections**  
Refer to Documents 2.7F and 2.7G for:  
• Sections 02-A & 02-D

**Bridge Plans**  
Refer to Documents 2.12C and 2.12 F for:  
• Bridges 12 & 13

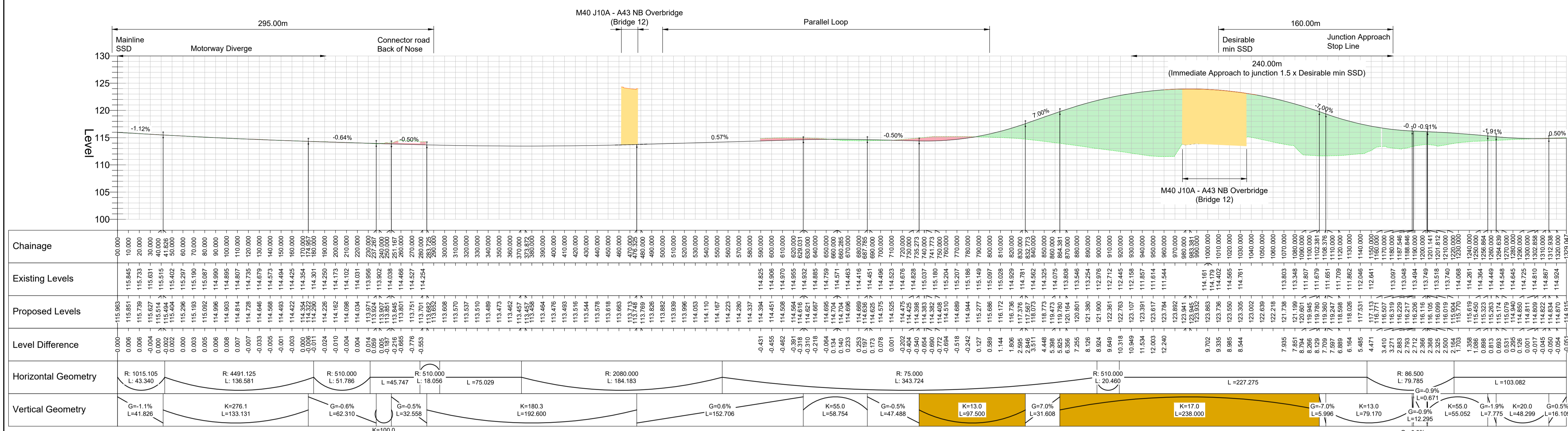

**M40 NB DIVERGE - PADBURY LONGSECTION**  
SCALE: H 1:2000, V 1:400. DATUM: 100.000

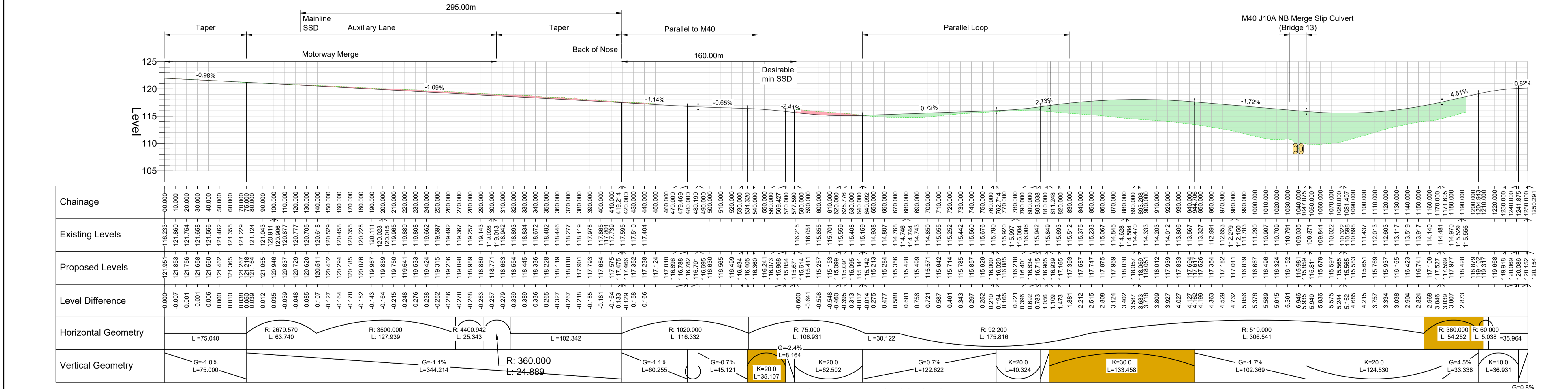

**M40 NB MERGE - ARDLEY LONGSECTION**  
SCALE: H 1:2000, V 1:400. DATUM: 105.000

P03	27.02.26	DCO Submission	RP	SRH	SRH
P02	02.02.26	Updated following consultation	RP	SRH	SRH
P01	30.07.25	Preliminary Issue	SB	SRH	SRH
Rev	Date	Details of issue / revision	Drw	CR'd	Apv

**Issues & Revisions**



**THE OXFORDSHIRE STRATEGIC RAIL FREIGHT INTERCHANGE AND HIGHWAYS ORDER 202X**

**HIGHWAY PLANS LONG SECTIONS SHEET 03**

Regulation:	6(2)	Document:	2.7P
Drawn:	S. Birchall	Checked:	S. Hilditch
Approved:	S. Hilditch	Date:	30.07.25
BWB Ref:	NTH2479	Scale@A1:	1:2000
Project - Originator - Functional Breakdown - Spatial Breakdown - Form - Discipline - Number			
<b>OxSRFI-BWB-HGN-03-DR-CH-0112</b>			
Drawing Status	DCO SUBMISSION		Rev
			<b>P03</b>